

Send original copy by certified mail to the Texas Water Development Board P. O. Box 12386 Austin, Texas 78711

State of Texas WATER WELL REPORT

For TWDB use only Well No. Located on map Received: Form GW 8 Form GW 9

1) OWNER: Person having well drilled Gholson Water Supply Corp. Address Rt. 5 Pox 3778 Waco, Texas

2) LOCATION OF WELL: McLennan County Labor League Abstract No. NW 1/4 NE 1/4 SW 1/4 SE 1/4 of Section Block No. 16 miles in N.W. direction from Waco, Texas

ST 40-22-307

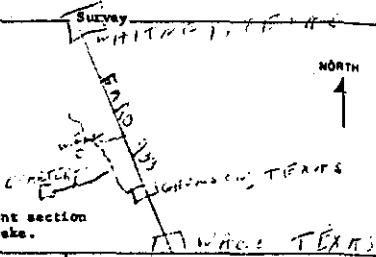

3) TYPE OF WORK (Check): New Well [X] Deepening [ ] Reconditioning [ ] Flugging [ ] 4) PROPOSED USE (Check): Domestic [ ] Industrial [ ] Municipal [X] Irrigation [ ] Test Well [ ] Other [ ] 5) TYPE OF WELL (Check): Rotary [X] Driven [ ] Dug [ ] Cable [ ] Jetted [ ] Bored [ ]

6) WELL LOG: Diameter of hole 11 in. Depth drilled 1180 ft. Depth of completed well 1160 ft. Date drilled 10/12/67 All measurements made from 3 ft. above ground level.

Table with 2 columns: From (ft.) To (ft.) Description and color of formation material. Rows include Top soil, clay & gravel & sand, yellow clay, clay & gravel, green shale, hard shale & gravel, limestone, limestone and shale.

7) COMPLETION (Check): Straight wall [ ] Gravel packed [ ] Other [ ] Under reamed [ ] Open hole [X] 8) WATER LEVEL: Static level 87 ft. below land surface Date 11/20/67 Artesian pressure lbs. per square inch Date

9) CASING: Type: old [ ] New [X] Steel [X] Plastic [ ] Other [ ] Cemented from 1130 ft. to 0 ft. 10) SCREEN: Type 3" black pipe Perforated [ ] Slotted [X]

Table with 2 columns: Diameter (inches) Setting From (ft.) To (ft.) Caga Slot size. Rows include 7 inch casing from 0 to 1130 ft. with 20 lb. caga, and 3 inch screen from 1110 to 1160 ft. with Torch slot size.

11) WELL TESTS: Was a pump test made? [X] Yes [ ] No If yes by whom? Smith Pump Co. Waco, Texas Yield: 150 gpm with 248 ft. drawdown after 20 hrs. 12) PUMP DATA: Manufacturer's Name No Pump Set To Re Set By Others Type g.P. Designed pumping rate gpm [ ] gph [ ] Type power unit Depth to bowls, cylinder, jet, etc., ft. below land surface.

I hereby certify that this well was drilled by me (or under my supervision) and that each and all of the statements herein are true to the best of my knowledge and belief. NAME V.O. Ward (Type or Print) Water Well Drillers Registration No. 471 Address P.O. Box 8201 Ft. Worth, Texas 76112 (Signed) V.O. Ward (Water Well Driller) Ward & Ward Drilling Co. (Company Name)

Please attach electric log, chemical analysis, and other pertinent information, if available. ST 40-22-307

# DRILLER'S LOG

0-1	TOP SOIL
1-15	CLAY, GRAVEL & SAND
15-30	YELLOW CLAY
30-64	CLAY & GRAVEL
64-80	GREEN SHALE
80-84	HARD SHALE & GRAVEL
84-230	LIMESTONE
230-242	LIMESTONE & SHALE
242-410	LIMESTONE
410-439	SHALE
439-539	LIMESTONE
539-556	SLATE & SHALE
556-562	SANDSTONE
562-1127	LIMESTONE
1127-1160	SAND
1160-1180	SLATE

# CHEMICAL ANALYSIS

	PPM
SODIUM (NA)	225
CALCIUM (CA)	1
MAGNESIUM (MG)	3
CHLORIDE (CL)	27
SULFATE (SO4)	110
CARBONATE (CO3)	6
BICARBONATE (HCO3)	420
IRON (FE)	0
NITRATE (NO3)	0
FLUORIDE (F)	0.4
BORON (B)	0
TOTAL ALKALINITY	348
TOTAL HARDNESS	16
TOTAL SOLIDS @ 110°C	600
PH	8.4

40-22-307



DRILLERS LOG

OWNER GIBLSON WATER SUPPLY CORPORATION

WELL LOCATION WELL LOCATED FOUR (4) MILES NORTHWEST OF GIBLSON, McLENNAN COUNTY, TEXAS

DRILLED BY WARD & WARD DRILLING CO. FT. WORTH, TEXAS

DRILLERS ELLIS V. & V.G. WARD

COMPLETED NOVEMBER 1967

DEPTH OF STRATA		EACH STRATUM	FORMATION
0	1	1	TOP SOIL
1	15	14	CLAY, GRAVEL & SAND
15	30	15	YELLOW CLAY
30	64	34	CLAY & GRAVEL
64	80	16	GREEN SHALE
80	84	4	HARD SHALE & GRAVEL
84	230	146	LIMESTONE
230	242	12	LIMESTONE & SHALE
242	410	168	LIMESTONE
410	439	29	SHALE
439	539	100	LIMESTONE
539	556	17	SLATE & SHALE
556	562	6	SALTS
562	1127	565	LIMESTONE
1127	1160	33	SAND
1160	1180	20	SLATE